

Küppersbusch

DIE WELT DER PROFIKÜCHE



PLATON SERVICE

8 (800) 500-34-47

www.platonservice.com

Ersatzteilliste

Spare parts list / Liste de pièces de rechange

KST120

KÜHLTECHNIK

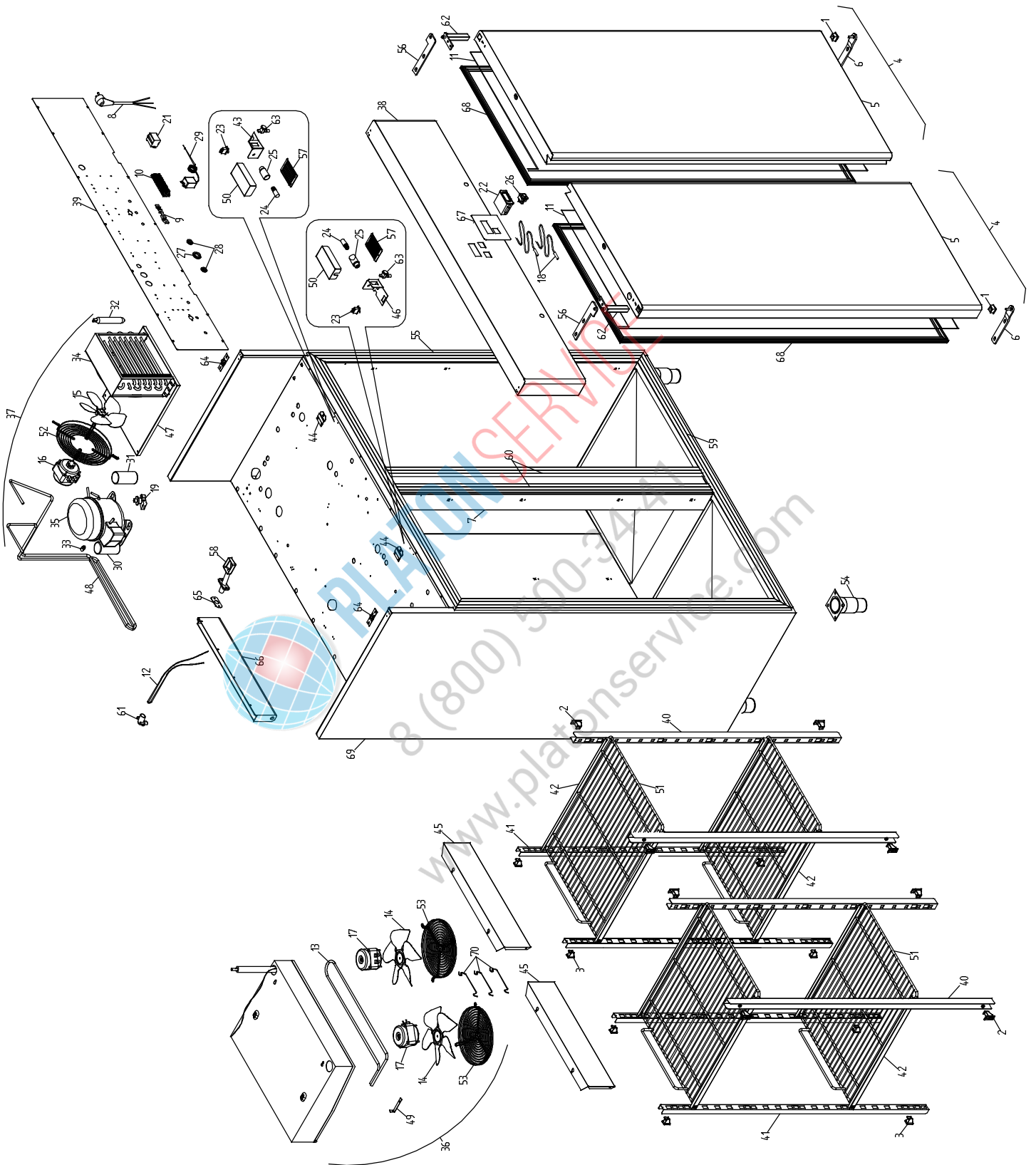

1	3178300	2	TAPPO PORTA	DOOR PLUG	TUERVERSCHLUSS	BOUCHON PORTE	TAPON PUERTA
2	3601350	12	SUPP. CREMAGLIERA	RACK SUPPORT	ROSTHALTER	SUPPORT CREMAILLIERE	SOPORTE CREMALLERA
3	3601360	12	SUPP. CREMAGLIERA	RACK SUPPORT	ROSTHALTER	SUPPORT CREMAILLIERE	SOPORTE CREMALLERA
4	60A3280	2	GRUPPO PORTA	DOOR UNIT	TUER KOMPL	GROUPE PORTE	GRUPO PUERTA
5	30F1510	2	PORTA FRIGO	FRIDGE DOOR	KUEHLSCHRANK	PORTE FRIGO	PUERTA CONG.
6	30T4510	2	STAFFA INFER.	BOTTOM BRACKET	UNTERER BUEGEL	ETRIER INFERIEUR	GANCHO INFERIOR
7	30T7870	1	MONTANTE CENT.	CENTRAL RISER	ZENT. STAENDER	MONTANT CENTRAL	MONTANTE CENT.
8	32A2200	1	CAVO ALIM.	POWER CABLE	SPEISEKABEL	CABLE ALIM.	CABLE ALIM.
9	32D0020	1	FISSACAVO	CABLE CLAMP	KABELHALTER	SERRE-CABLE	FIJA CABLE
10	32D1750	1	MORSETTIERA	TERMINAL BOARD	KLEMMENBRETT	BOITE A BORNES	ENCHUFE
11	32G3540	2	RESISTENZA	RESISTOR	WIDERSTAND	RESISTANCE	RESISTENCIA
12	32G2420	1	RESISTENZA	RESISTOR	WIDERSTAND	RESISTANCE	RESISTENCIA
13	32G3100	1	RESISTENZA	RESISTOR	WIDERSTAND	RESISTANCE	RESISTENCIA
14	32M1550	2	VENTOLA	FAN	FLUEGELRAD	HELICE	ALABE
15	32M2260	1	VENTOLA	FAN	FLUEGELRAD	HELICE	ALABE
16	3043560	1	MOTORE VENTIL.	FAN MOTOR	VENTILATORMOTOR	MOTEUR VENTIL.	MOTOR VENTIL.
17	32M7020	2	MOTORE VENTIL.	FAN MOTOR	VENTILATORMOTOR	MOTEUR VENTIL.	MOTOR VENTIL.
18	32V6010	2	SONDA NTC	POROB NTC	FÜHLER NTC	SONDE NTC	SONDA NTC
19	32Z7620	1	RELE'	RELAY	RELAY	RELAIS	RELAIS
21	32V3720	1	RELE'	RELAY	RELAY	RELAIS	RELAIS
22	32V7650	1	TERMOREGOLATORE	THERMOREGULATOR	THERMOREGULATOR	THERMOREGULATEUR	THERMOREGULADOR
23	32W3770	2	MICROINTER.	MICROSWITCH	MIKROSCHALTER	MICROINTER.	MICROINTER.
24	32W3790	2	LAMPADA	LIGHT	LAMPE	LAMPE	LAMPARA
25	32W3800	2	P. LAMPADA	LAMP-HOLDER	LAMPENFASSUNG	PORTE-LAMPE	P/LAMPARA
26	32W3970	1	INTERR. BIPOL.	BIPOLAR SWITCH	ZWEIPOL. SCHALTER	INTER. BIPOL.	INTER. BIPOLAR
27	32X0120	1	PASSACAVO	GROMMET	KABELDURCHGANG	PASSE-CABLE	PASACABLE
28	32X0140	2	PASSACAVO	GROMMET	KABELDURCHGANG	PASSE-CABLE	PASACABLE
29	32Z1090	1	TERMOST. SICUR.	SAFETY THERMOSTAT	SICHERHEITSTHERMOS.	THERMOSTAT DE SECURITE	TERMOS. DE SEGUR.
30	32Z7720	1	CONDENSATORE	CONDENSER	KONDENSATOR	CONDENSEUR	CONDENSADOR
31	32Z9130	1	CONDENSATORE	CONDENSER	KONDENSATOR	CONDENSEUR	CONDENSADOR
32	33A0190	1	FILTRO	FILTER	FILTER	FILTRE	FILTRO
33	33A1200	1	VALV.SERVIZIO	AUXIL. VALVE	BETRIEBSVENTIL	SOUPAPE DE SERV.	VALV.DE SERV.
34	34D4821	1	CONDENS.+CONV.	CONDEN.+BAFFLE	KONDEN.+HAUBE	CONDEN.+CONV.	CONDEN.+TRANSM.
35	34D4560	1	COMPRESSORE	COMPRESSOR	KOMPRESSOR	COMPRESSEUR	COMPRESOR
36	34D9370	1	AEROEVAPORATORE	EVAPORATOR	VERDAMPFER	EVAPORATEUR	EVAPORADOR
37	34E2860	1	GRUPPO MOTORE	MOTOR UNIT	AGGREGAT	GROUPE MOTEUR	GRUPO MOTOR
38	35E7010	1	CRUSCOTTO	CONTROL BOARD	SCHALTERBLENDE	TABLEAU	TABLERO

.....	39	35H1820	1	PROTEZ. COMPON.	COMPONENT GUARD	KOMPONENTENSCHUTZ	PROTECTION PIECES	PROTECCION COMPON.
.....	40	35Y8570	4	CREMAGLIERA	RACK	ZAHNSTANGE	CREMAILLIERE	CREMALLERA
.....	41	35Y8560	4	CREMAGLIERA	RACK	ZAHNSTANGE	CREMAILLIERE	CREMALLERA
.....	42	35Y3430	16	GUIDA GRIGLIE	GUIDE	FUEHRUNG	GLISSIERE	GUIA
.....	43	35R9260	1	SUPP. SERRATURA DX	LOCK SUPPORT	SCHLOSSTUETZE	SUPPORT SERRURE	SOPORTE CERRADURA
.....	44	35R9320	2	SUPP. CRUSCOTTO	SUPPORT	HALTER	SUPPORT	SUPORTE
.....	45	35R9451	2	CARTER EVAP.	EVAPORATOR GUARD	VERDAMPFERSCHUTZ	PROTECTION EVAPOR.	PROTECCION EVAPOR.
.....	46	35U4230	1	SUPP. SERRATURA SX	LOCK SUPPORT	SCHLOSSTUETZE	SUPPORT SERRURE	SOPORTE CERRADURA
.....	47	35W4350	1	BAGIN. GRUPPO	ASSEMBLY TRAY	AUFFANG. GR.	BAC GROUPE	CONT. GRUPO
.....	48	35X5281	1	SERPENTINA	PIPE COIL	SCHLANGE	SERPENTIN	SERPENTIN
.....	49	35Y2000	1	SUPPORTO SONDA	SUPPORT	HALTER	SUPPORT	SUPORTE
.....	50	35Y3090	2	PROTEZIONE LAMPADA	LAMP GUARD	LAMPENSCHUTZ	PROTECTION LAMPE	PROTECCION LAMPARA
.....	51	36A5380	8	GRIGLIA	GRID	ROST	CLAYETTE	REJILLA
.....	52	36C2010	1	PROTEZ. VENTIL.	FAN.PROT.	VENTILATORSCH.	PROT.VENTIL.	PROT.VENTILAD.
.....	53	36C4790	2	PROTEZ. VENTIL.	FAN.PROT.	VENTILATORSCH.	PROT.VENTIL.	PROT.VENTILAD.
.....	54	36C5550	4	PIEDE	FOOT	FUSS	PIED	PIE
.....	55	36E4890	2	PROFILO CORNICE	FRAME TRIM	PROFIL RAHMEN	LISTEAU CADRE	PERFIL MARCO
.....	56	36E2120	2	STAFFA SUPERIORE	TOP BRACKET	OBERKASTEN	ETRIER SUPERIEUR	GANCHO SUPERIOR
.....	57	36E2240	2	VETRINO PROTEZIONE LAMP	LAMP PROTECTION GLASS	LAMPENSCHUTZGLAS	VERRE PROTECTION LAMPE	LAMINA DE VIDRIO PROTE
.....	58	36E2270	1	CONVOGLIATORE CONDEN	CONDENS. DRAIN	KONDENSABFLUSS	DECHARGE GOUTTES	DESCARGA COND.
.....	59	36E2280	2	PROFILO CORNICE	FRAME TRIM	PROFIL RAHMEN	LISTEAU CADRE	PERFIL MARCO
.....	60	36E4960	2	PROFILO CORNICE	FRAME TRIM	PROFIL RAHMEN	LISTEAU CADRE	PERFIL MARCO
.....	61	36E3870	1	SCARICO CONDENSA ESTE	CONDENS. DRAIN	KONDENSABFLUSS	DECHARGE GOUTTES	DESCARGA COND.
.....	62	36G6520	2	CERNIERA	HINGE	SCHARNIERE	CHARNIERE	VISAGARA
.....	63	36M7070	2	SERRATURA CHIAVE	KEY LOCK	SCHLUESSELSCLOSS	SERRURE CLEF	CERRADURA LLAVE
.....	64	36M7080	2	CERNIERA FISS. CRUSCOT	HINGE	SCHARNIERE	CHARNIERE	VISAGARA
.....	65	36Z1410	1	GUARNIZ. SCARICO	GASKET	DICHTUNG	GARNITURE	EMPACADURA
.....	66	36Z1530	1	BACIN. COND.	COND. TRAY	KONDENSCHALE	BAC GOUTTES	RECOGEDOR COND.
.....	67	37N6470	1	PANN. SERIG.	SILK-SCREE.PANEL	SIEBGEDR. TAFEL	PANNEAU SERIG.	PANAL SERIG.
.....	68	37Q5450	2	GUARNIZ. PORTA	DOOR GASKET	TUERDICHTUNG	GARNITURE PORTE	EMPACADURA
.....	69	40K1606	1	SCOCCA	BODY	KAROSSE	CHASSIS	CHASSIS
.....	70	36M2300	3	MOLLA	RESSORT	FEDER	SPRING	RESORTE